

Tavola 1 - Stato Autorizzato ( Deliberazione 1959 )



Tavola 2 - Stato Attuale



Tavola 3 Stato a Sanatoria, post demolizione

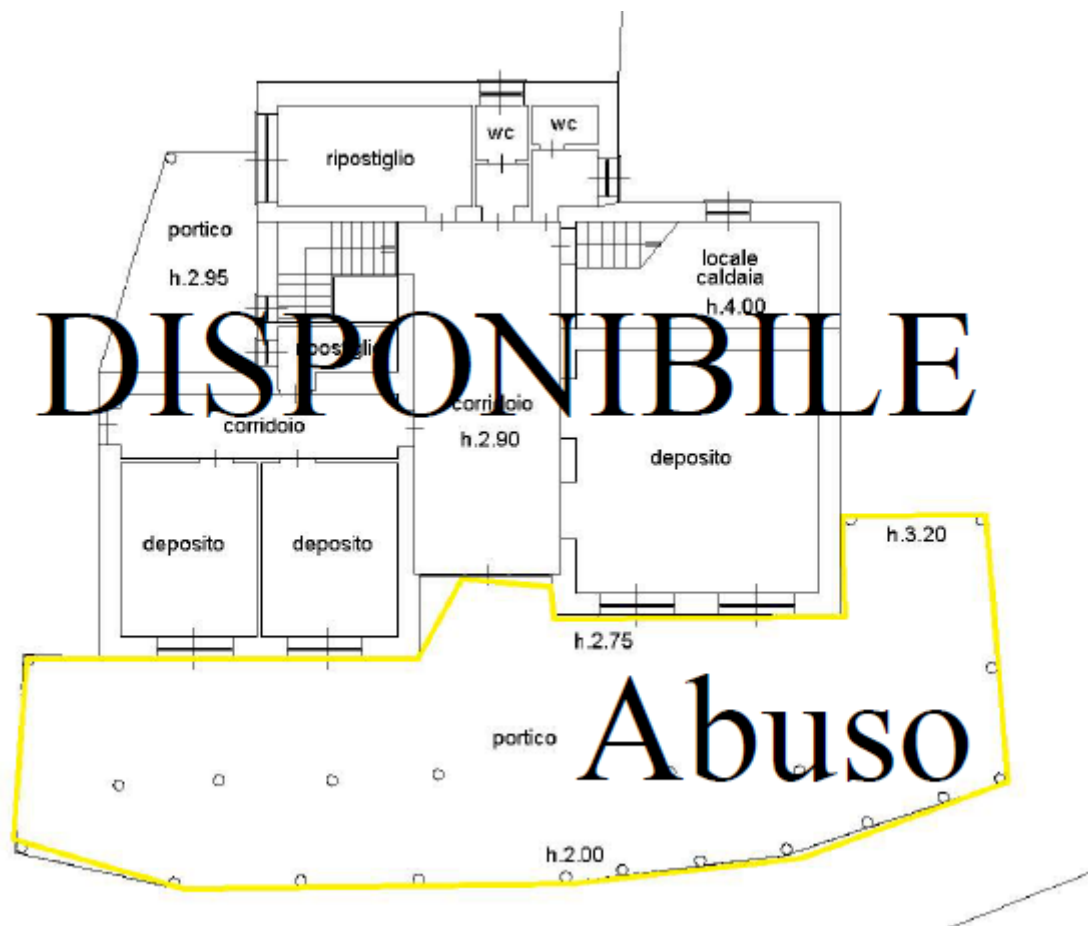

Tavola 4 Raffronto

Tipo di Intervento : Permesso di Costruire

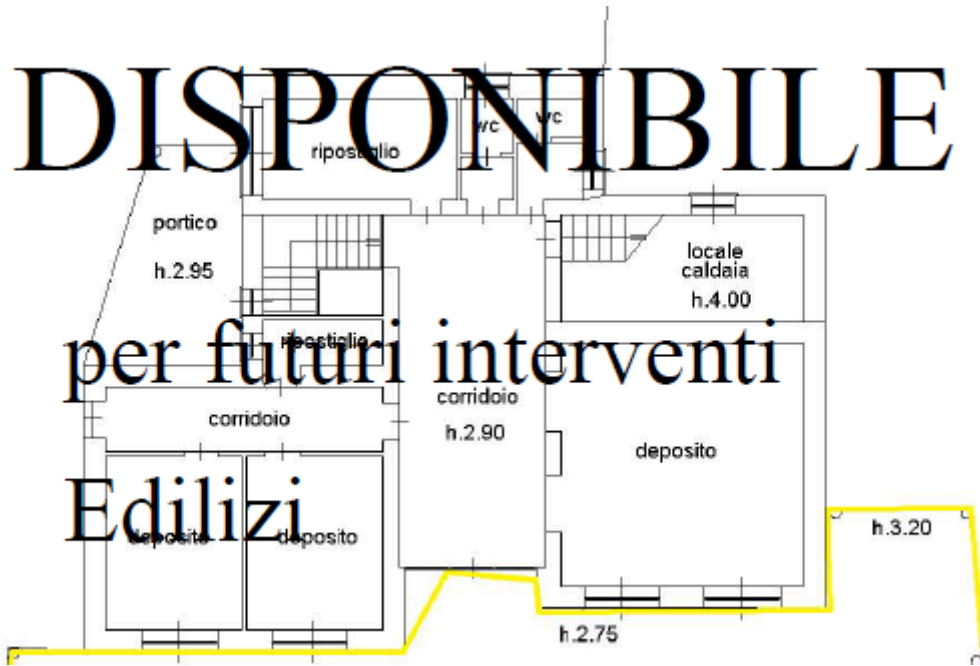
Costi : Diritti di segreteria € 100

Sanzione per cambio d'uso ex scuola a disponibile € 1.032

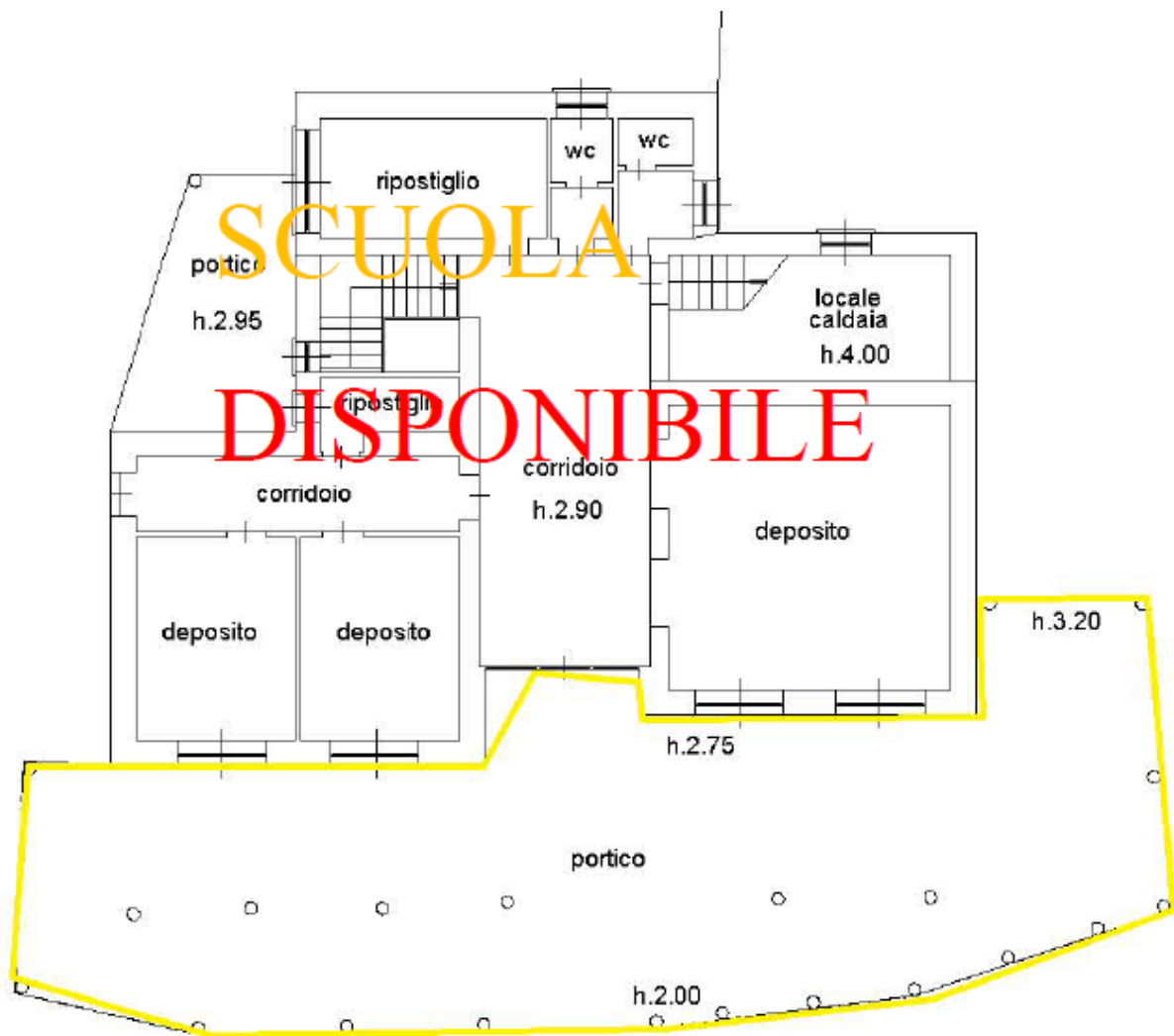
# DISPONIBILE

per futuri interventi

## Edilizi

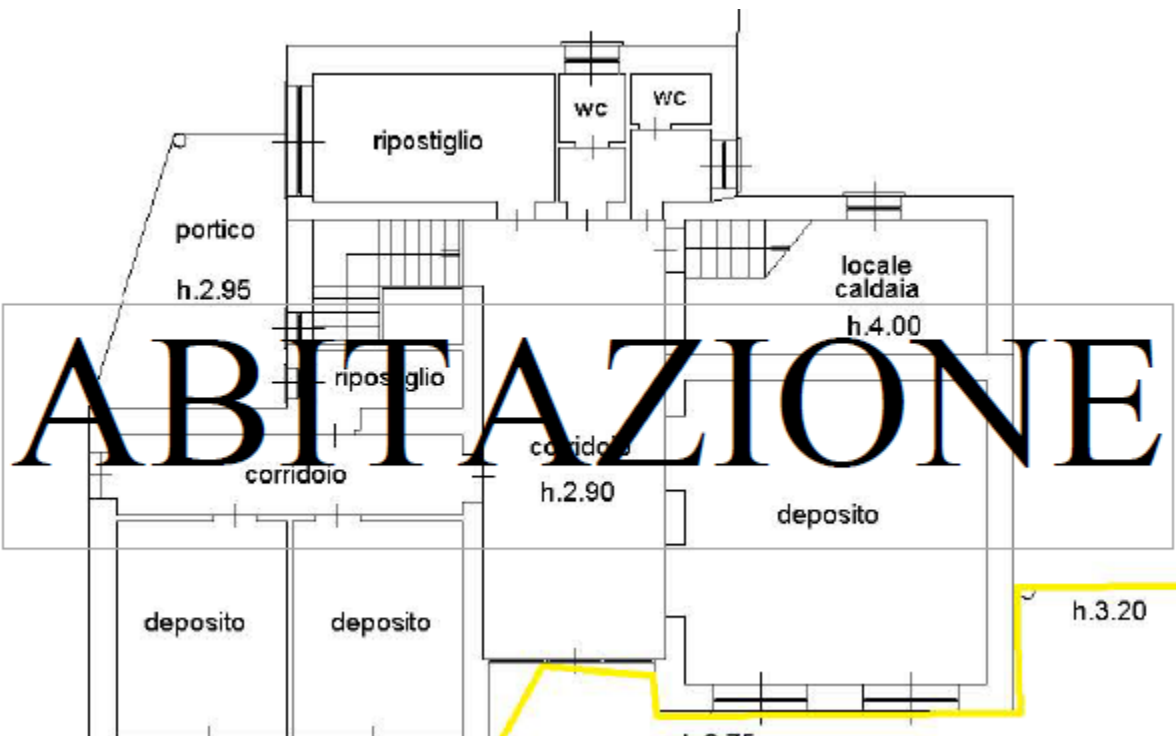
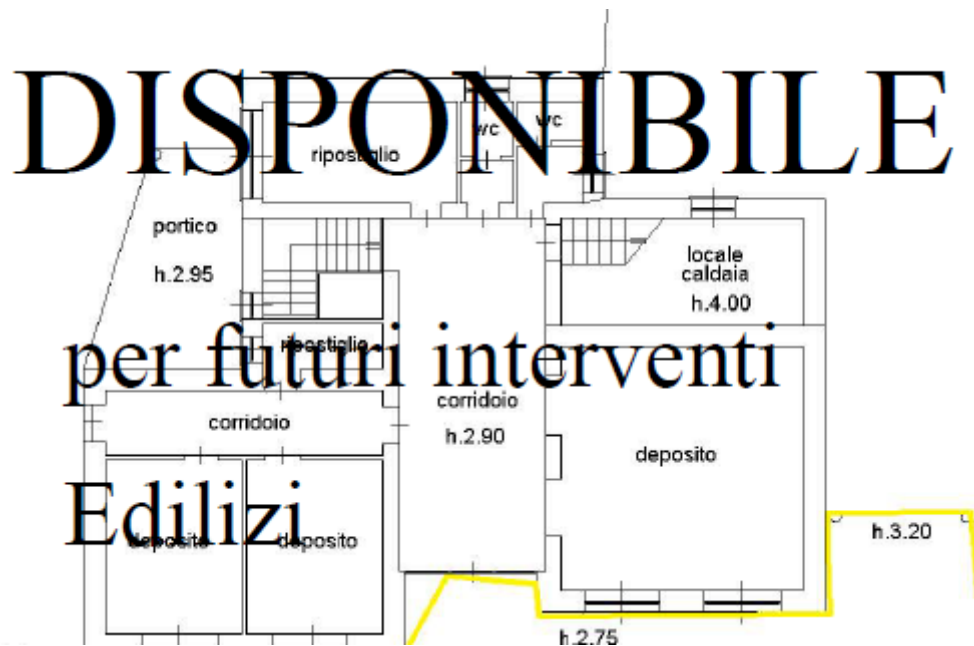

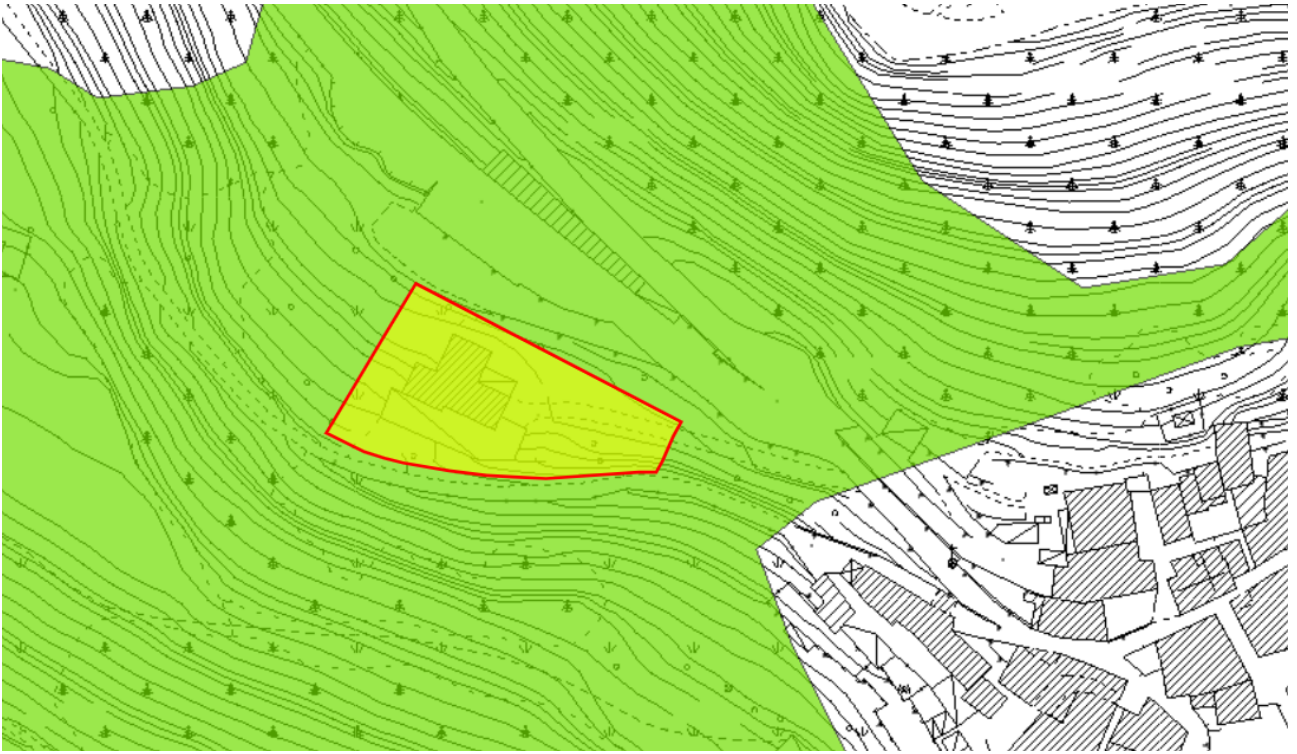

Vincolo Idrogeologico SI pratica ????



Ambientale NO