

E=1581700

I Particella: 440

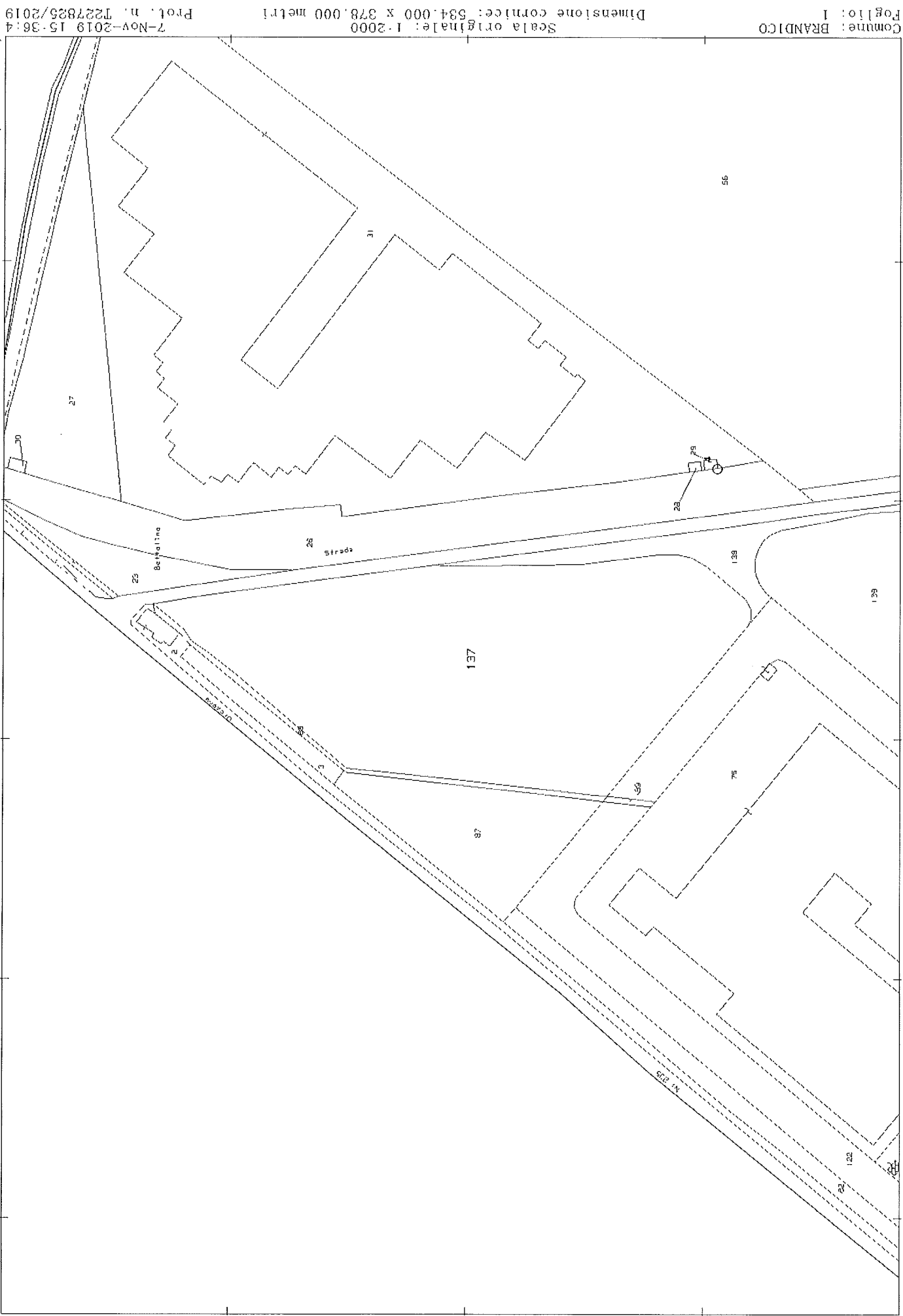

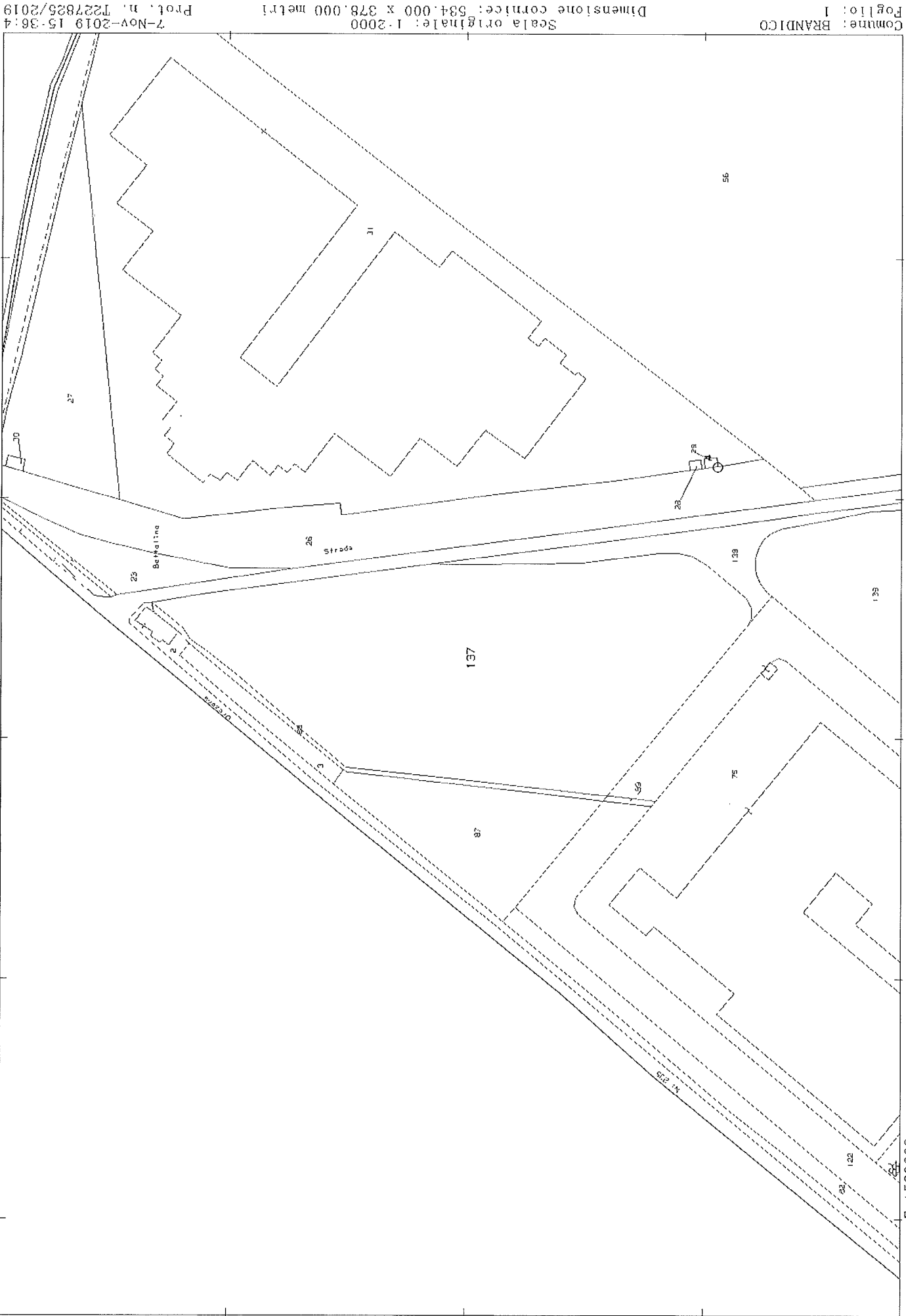



N=5035300

E=1580600

I Particella 137



N=5056500

E=1597000

I Particella 795



N=5056700

E=1697800

l. Particella: 181



ESTRATTO DI MAPPA FOGLIO 4  
MAPPALE N°419(Scala 1:2000)

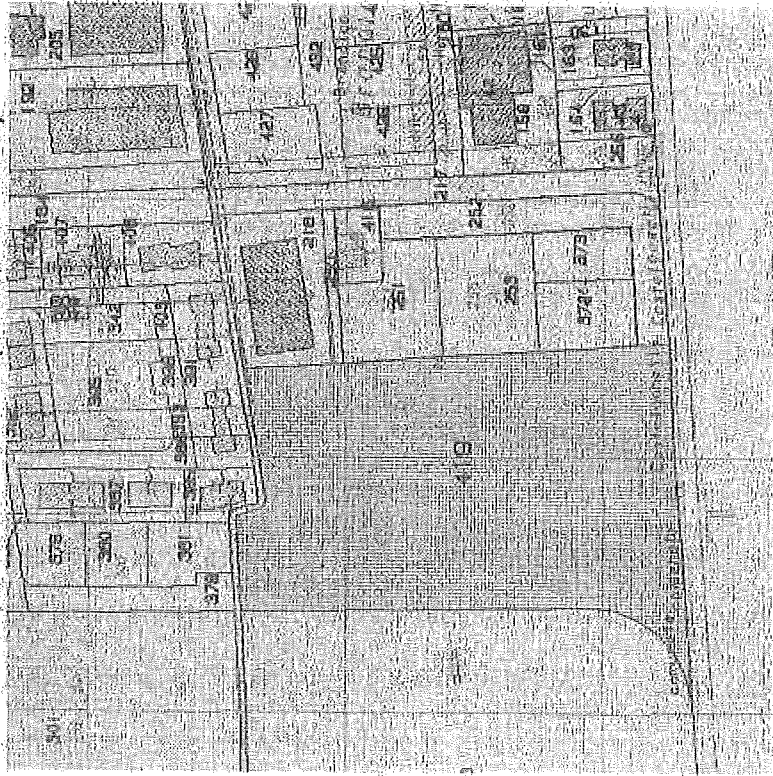

ESTRATTO DI PRG (Scala 1:2000)

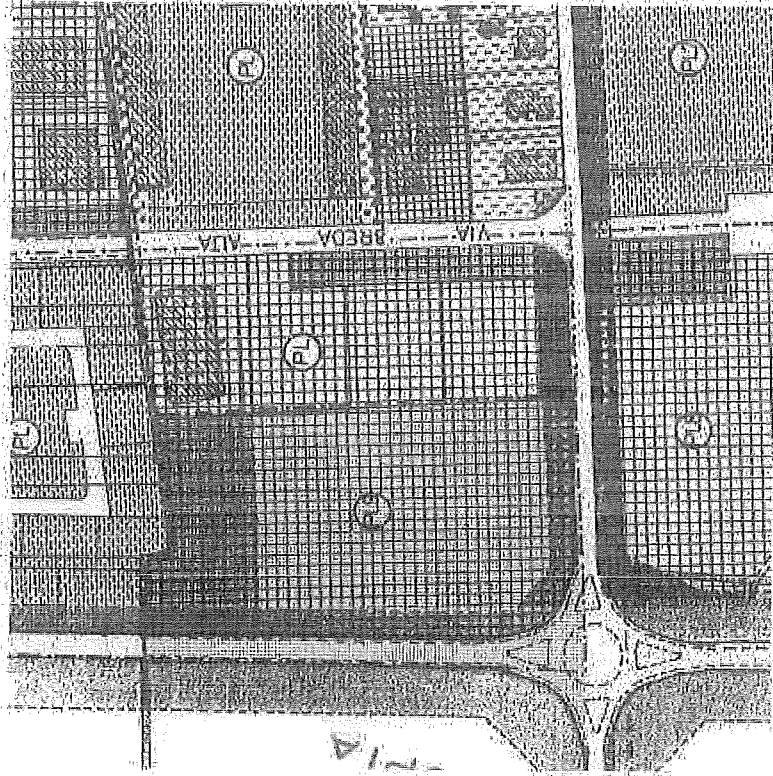

PLANIMETRIA DI PROGETTO - Scala 1/500  
COME DA DIA prot. 3209 del 26/09/2007

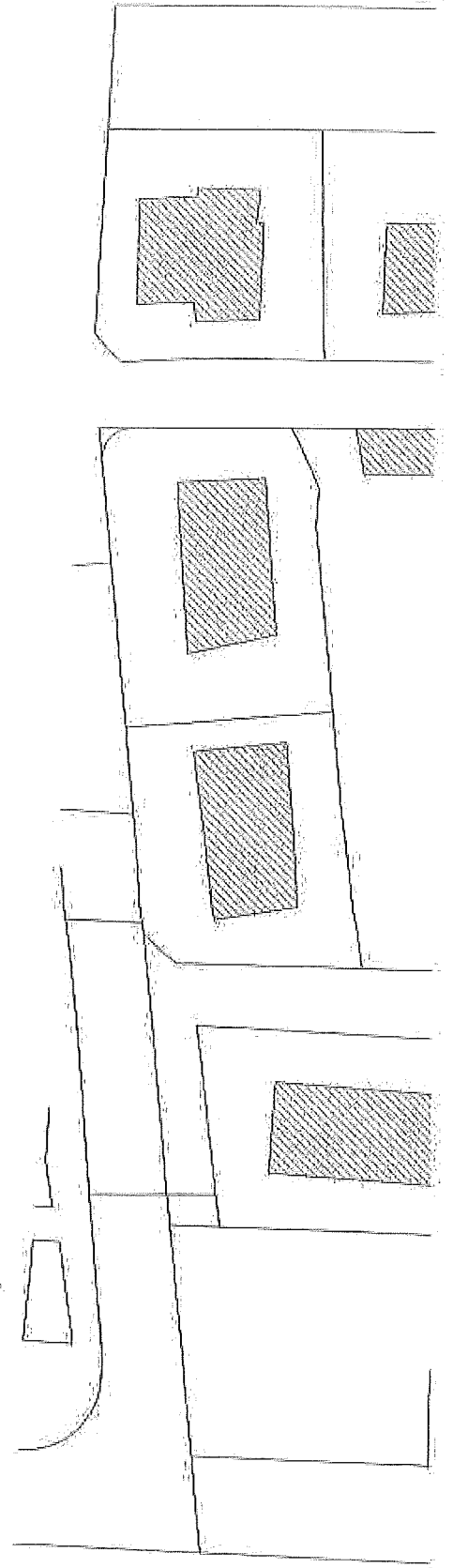





111

VIA BREDA ALTA

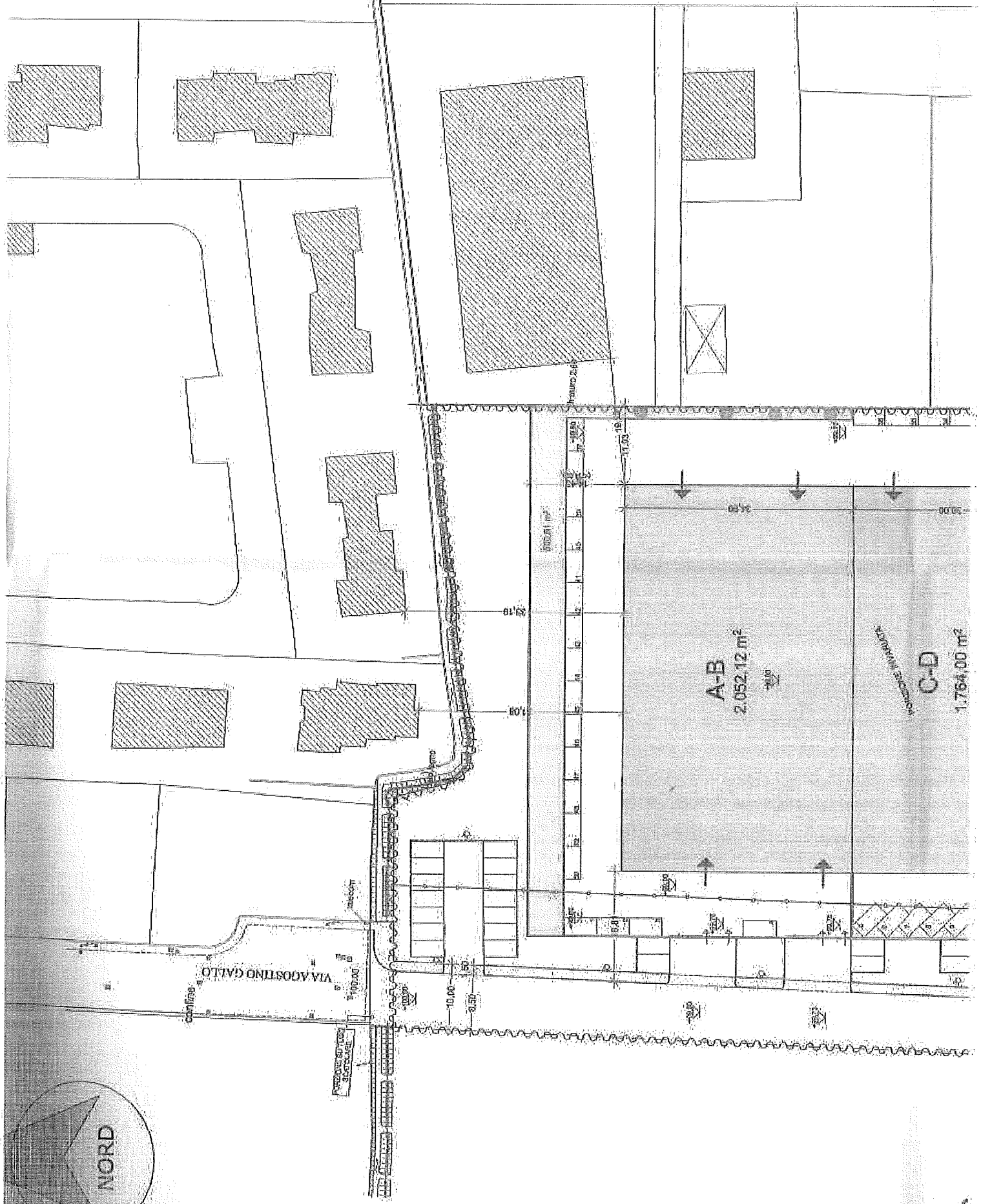

NORD

LA BREDA ALTA

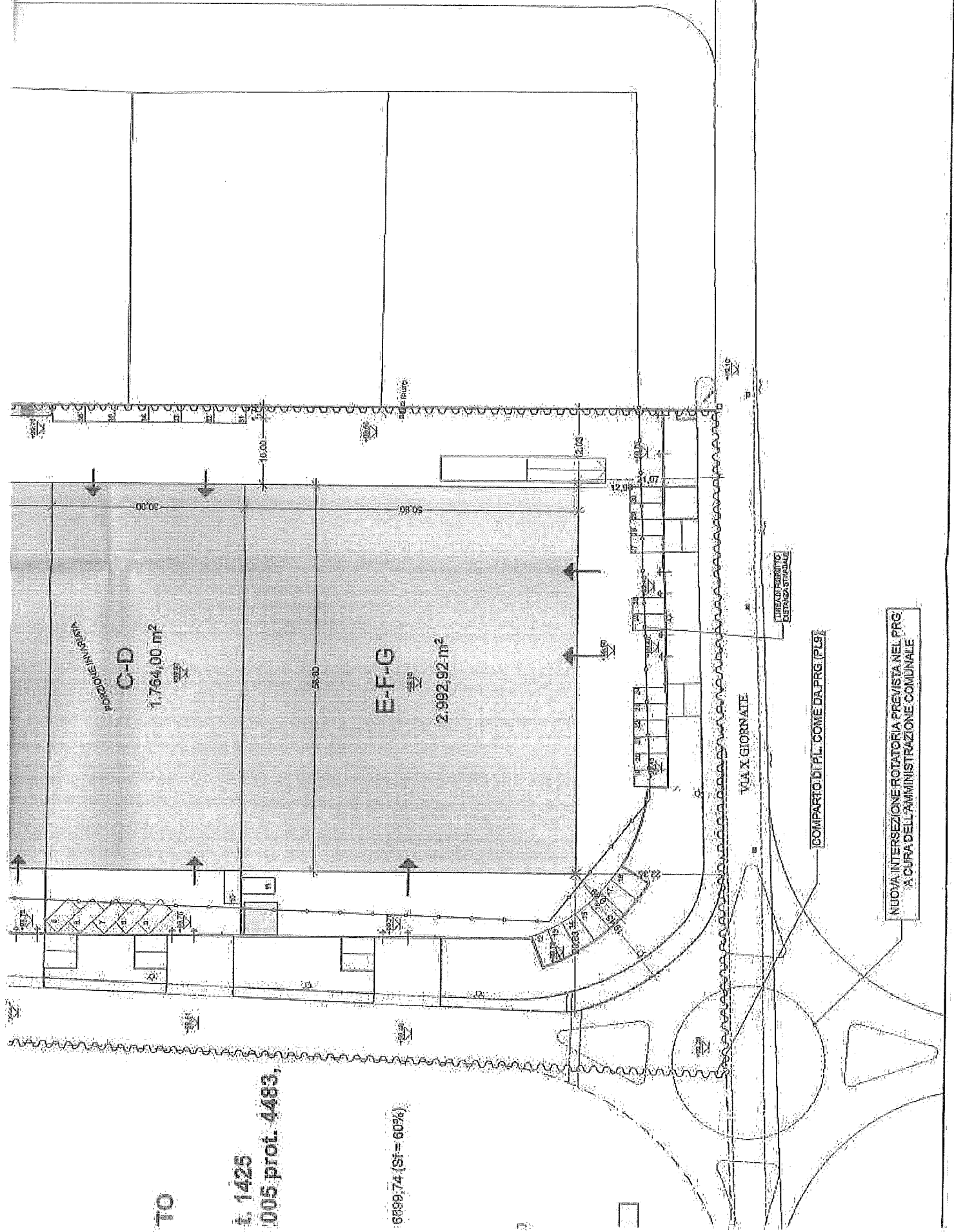

TO

1.1425  
005 prot. 4483,

6089,74 (Sf = 60%)

VIA X GIORNATE

DIREZIONE STRADALE

COMPARTO DI P.L. COME DA PRG (P.U.S.)

NUOVA INTERSEZIONE ROTATORIA PREVISTA NEL PRG  
A CURA DELL'AMMINISTRAZIONE COMUNALE

PLANIMETRIA DI PROGETTO - Scala 1/500

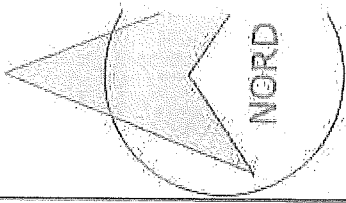
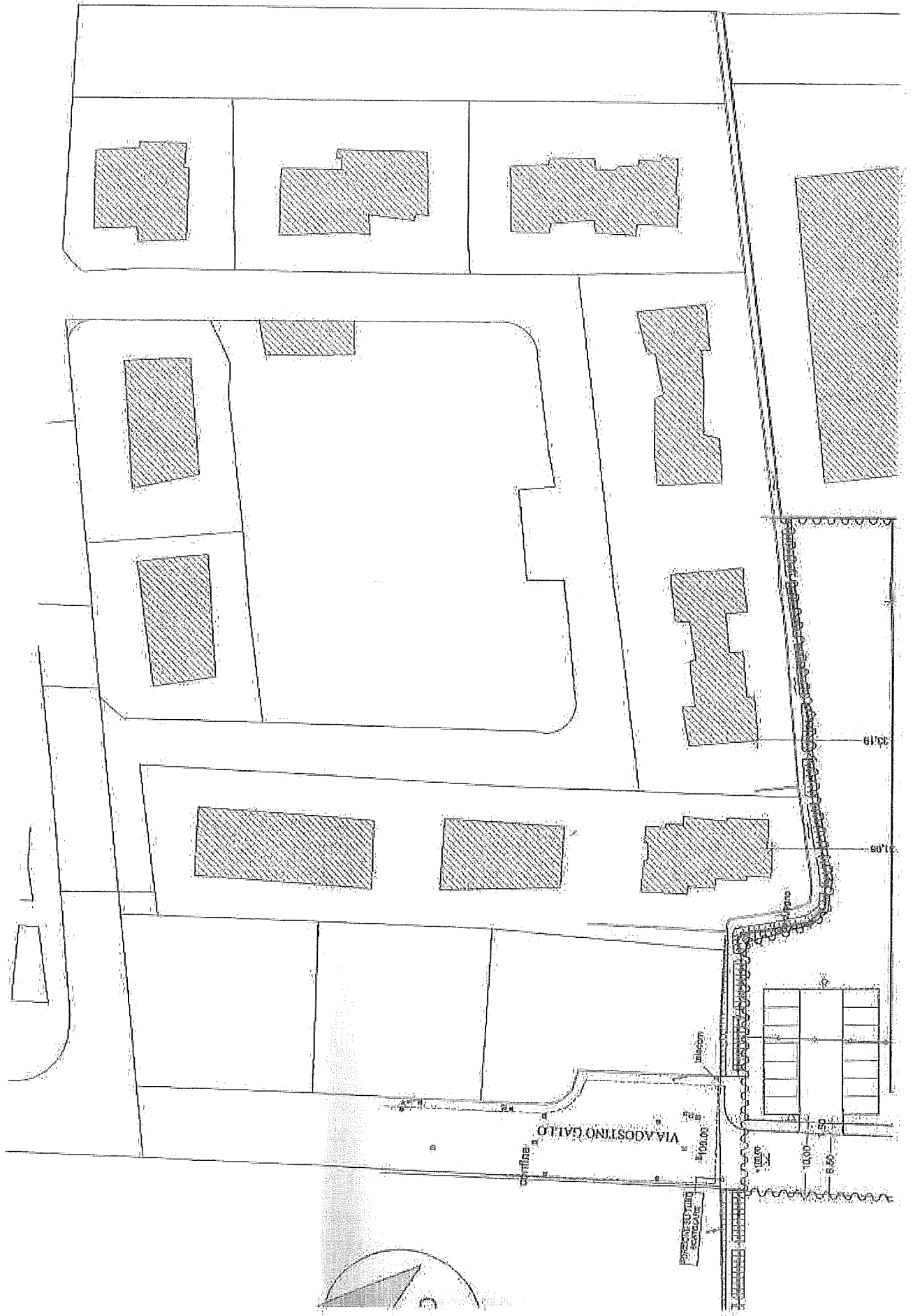

Scale 1/500

VIA BREDA ALTA

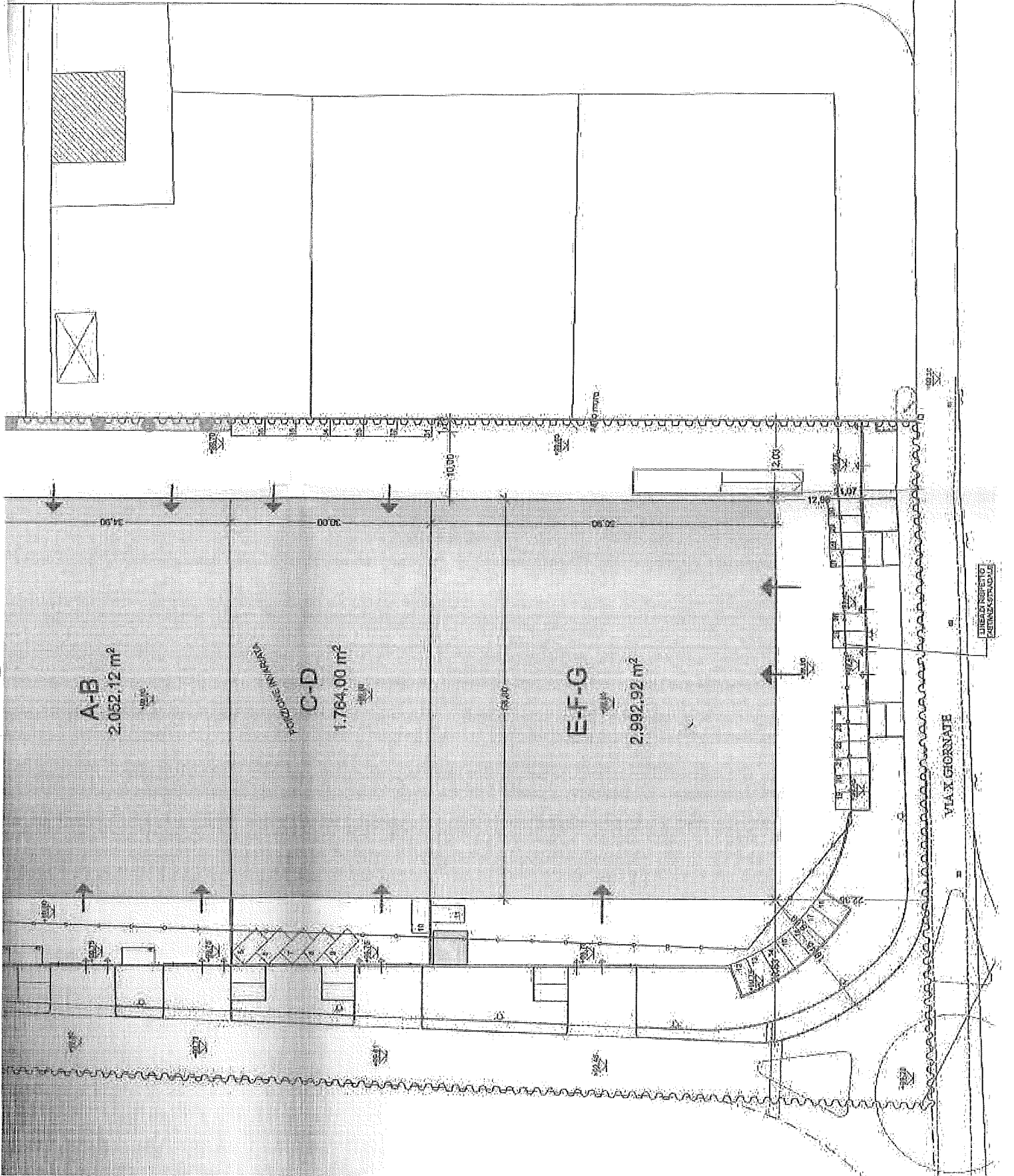



BREDA ALTA

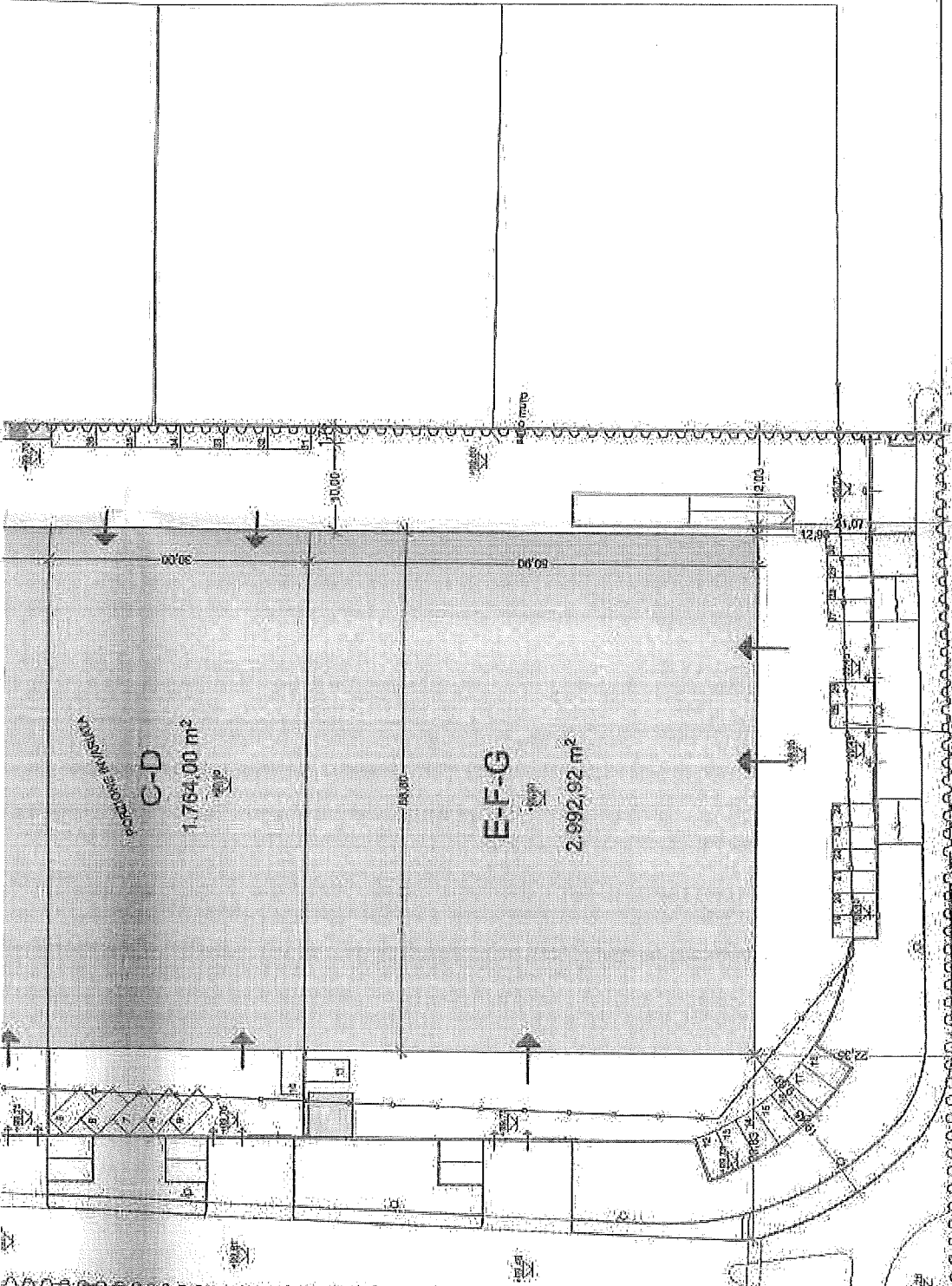

1,764.00 m<sup>2</sup>  
C-D

2,992.92 m<sup>2</sup>  
E-F-G

VIA N. GIORNATE

UNIVERSITARIO

COMPLETO DI P.L. COME DA PRG (P.L.)

NUOVA INTERSEZIONE ROTATORIA PREVISTA NEL PRG  
A CURA DELL'AMMINISTRAZIONE COMUNALE

**PLANIMETRIA DI PROGETTO - Scala 1/500**  
**SOVRAPPOSIZIONE**

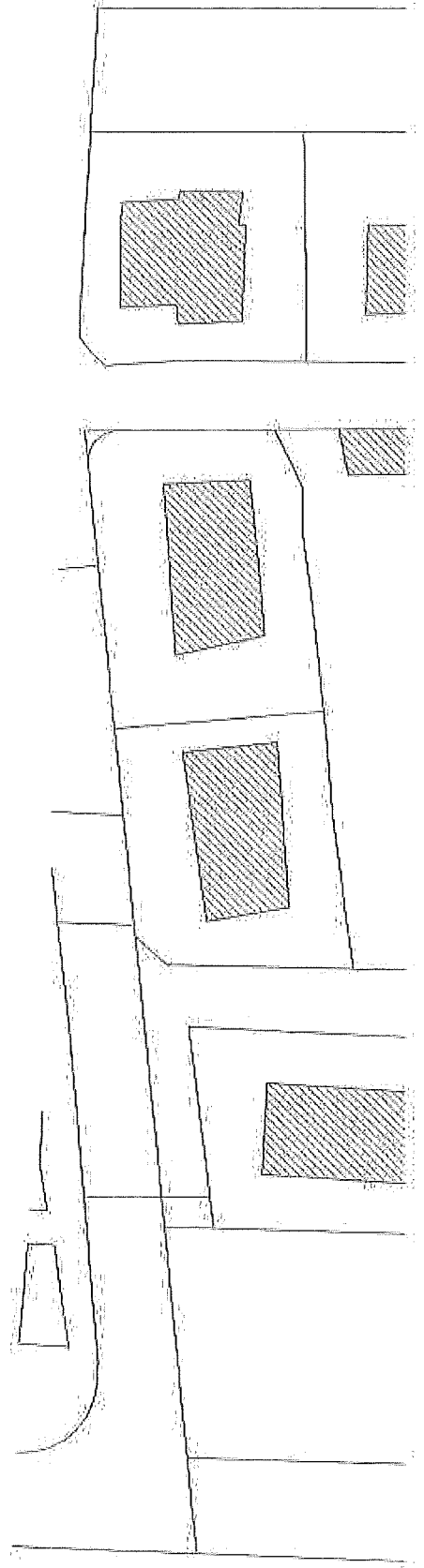



TABREDA ALTA

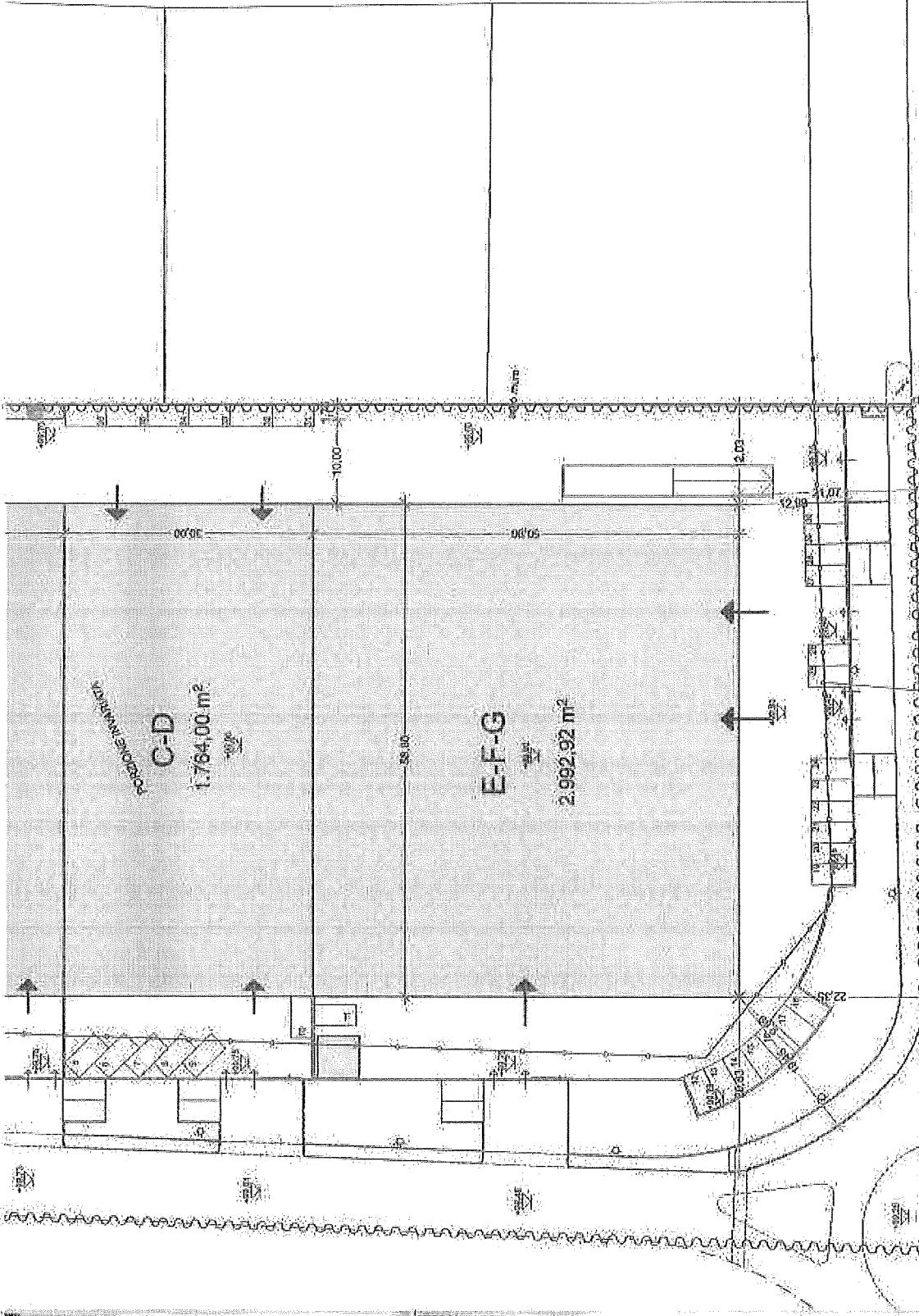

LINEARI RINVIETTO  
D'ASTA SPAZIONALE

VIA X GIORNATE

COMPARTO DI P.L. COME DA PRG (PLS)

NUOVA INTERSEZIONE ROTATORIA PREVISTA NEL PRG  
A CURA DELL'AMMINISTRAZIONE COMUNALE





