

MODULARIO
F. rig. rend. 487



MINISTERO DELLE FINANZE

DIREZIONE GENERALE DEL CATASTO E DEI SS.TT.EE.

CATASTO EDILIZIO URBANO (RDL 13-4-1939, n. 652)

cod. n. 8408/97

MOD. EN (CEU)

LIRE
250

Planimetria di u.i.u. in Comune di SAN ZENO NAVIGLIO via ROMA

civ. 36

P. TERRA

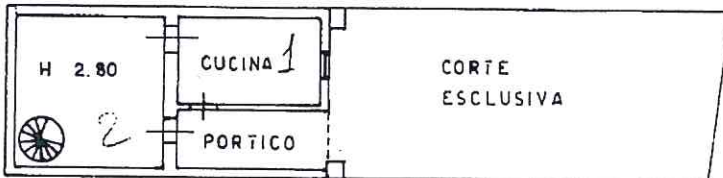

P. PRIMO

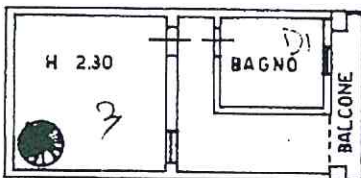

P. SECONDO

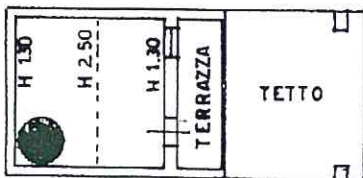

ORIENTAMENTO



SCALA DI 1:200

Catasto dei Fabbricati - Situazione al 03/10/2018 - Comune di SAN ZENO NAVIGLIO (1412) - Foglio: 12 - Particella: 208 - Subalterno: 0 >
VIA ROMA n. 36 piano: 1-1-2;

Dichiarazione di N.C.

Denuncia di variazione

Ultima planimetria in atti

Compilata dal GEOMETRA
(Titolo, cognome e nome)
GABRIELLI GIOVANNI

RISERVATO ALL'UFFICIO

Data presentazione: 21/02/1997 - Data: 03/10/2018 - n. T55272 - Richiedente: MGLVTL40S11C760S

Totale schede: 1 - Formato di acquisizione: A4 (210x297) BR 05640 stampa ritaglio: A4 (210x297) 72

n. 208 sub.

data 13.02.97 Firma *G. Gabrielli*





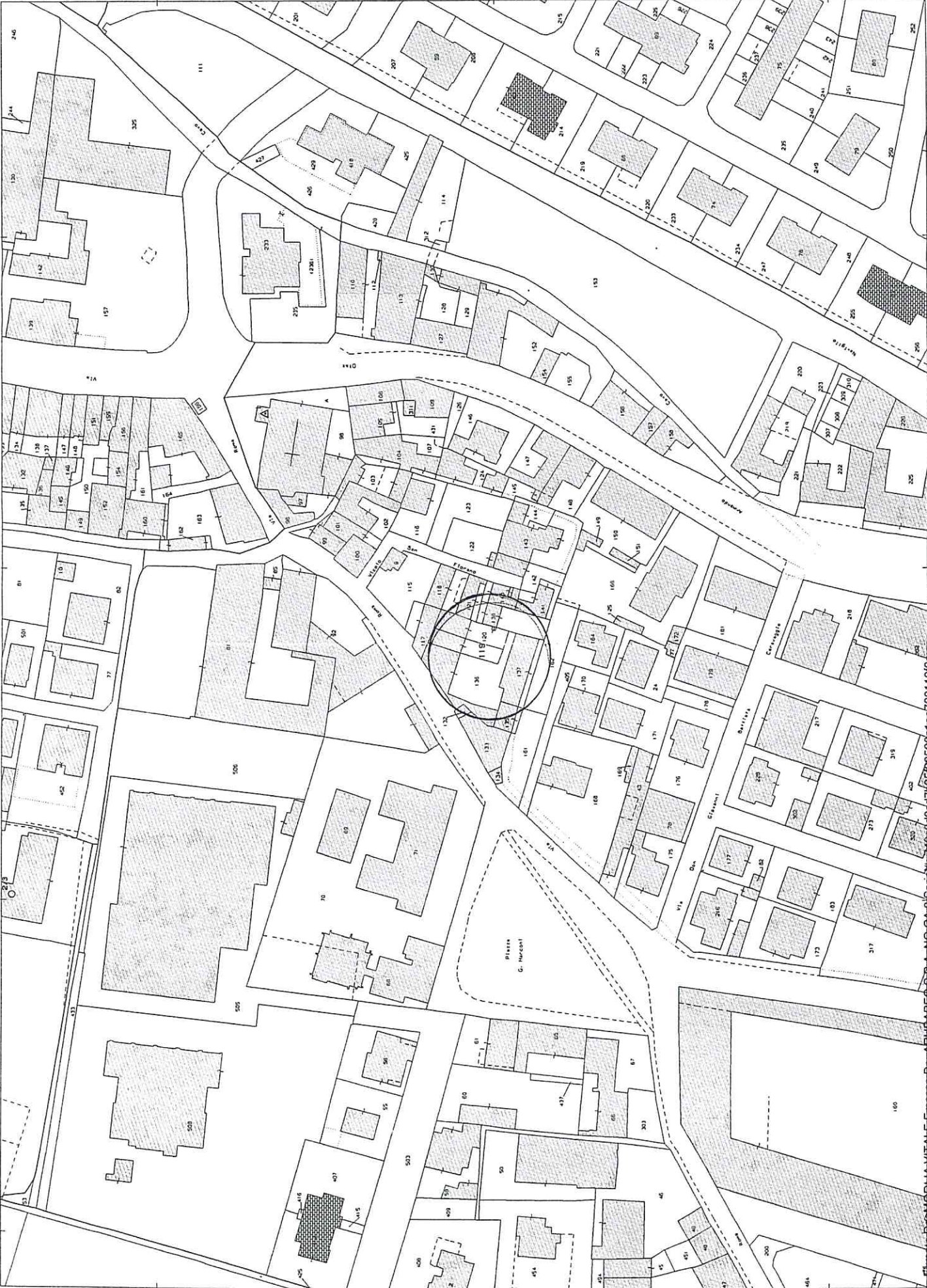

21 FEB 1997

Doo 413





















Legenda

-  Confine comunale
-  nuclei di antica formazione
-  Ambiti di Trasformazione
-  perimetro D1 dell'ambito a riconversione residenziale secondo le prescrizioni accolte

Beni costitutivi dell' identità del paesaggio

-  zona A1
-  zona A2
-  Beni individuati, artt. 2, 3, 4 del T.U. 490/99
 - 1- La Pontevica Cascina e Corte Rurale
 - 2 - Chiesa dell'Assunta
 - 3 - Chiesa San Zenone Vescovo
 - 4 - Canonica
 - 5 - Cimitero
-  ZONA E1 - agricola di valore paesistico ambientale
-  ZONA E3 - agricola di tutela e riqualificazione ambientale
-  naviglio
-  corsi d'acqua con andamento naturale o di interesse paesaggistico
-  fontanili
-  Filari di alberi, alberi isolati e di particolare interesse
-  Presenza di alcuni individui a portamento arboreo di macchie di vegetazione in avanzata evoluzione verso forme forestali
-  Vegetazione ripariale
-  Specchi d'acqua - laghetto di cava

Classi di sensibilità paesistica

-  molto bassa
-  bassa
-  media
-  elevata
-  molto elevata

